

BACK DOOR OPENING LOWER REINFORCEMENT (ASSY) REPLACEMENT

1. REMOVE QUARTER PANEL ([See page BP-47](#))
2. REMOVE BODY LOWER BACK PANEL ([See page BP-56](#))
3. REMOVE BACK DOOR OPENING TROUGH ([See page BP-69](#))
4. REMOVE BACK DOOR OPENING LOWER REINFORCEMENT

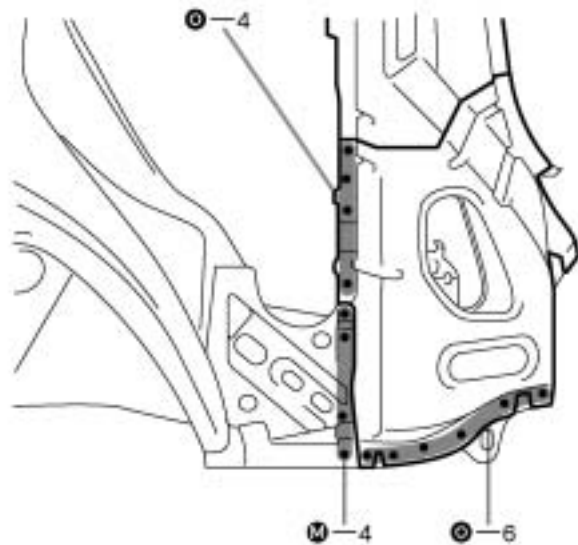

5. INSTALL BACK DOOR OPENING LOWER REINFORCEMENT

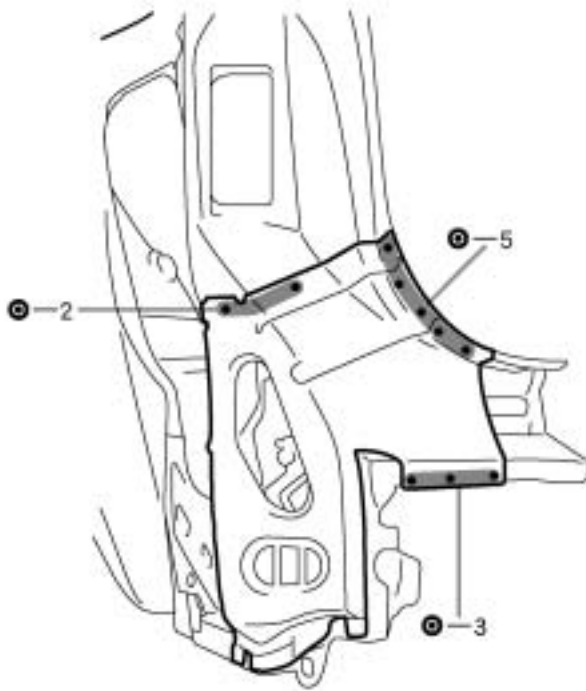
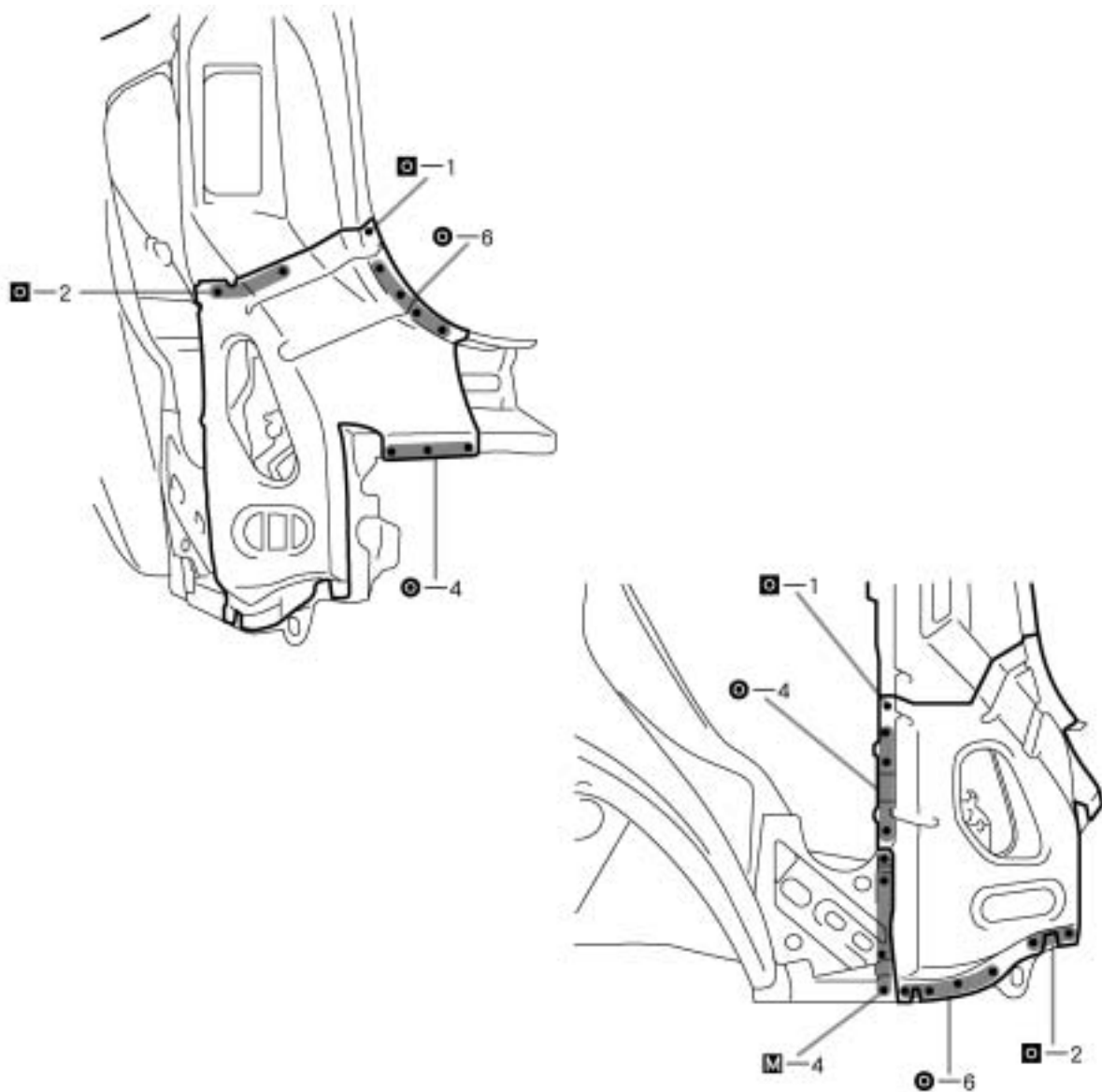

F12261

6. MEASURING OPENING PORTION DIMENSIONS ([See page BP-94](#))
7. INSTALL BACK DOOR OPENING TROUGH ([See page BP-69](#))
8. INSTALL BODY LOWER BACK PANEL ([See page BP-56](#))
9. INSTALL QUARTER PANEL ([See page BP-47](#))
10. APPLYING SEALER TO THE INSIDE OF THE VEHICLE ([See page PC-1](#))
11. APPLYING SEALER TO THE REAR LUGGAGE COMPARTMENT ([See page PC-1](#))
12. APPLYING UNDER COATING ([See page PC-6](#))
13. APPLYING ANTI-RUST AGENT
 - (a) After applying the top coat layer, apply the anti-rust agent to the inside of the necked section structural weld spots.